

B

You'll only need one but we gave you extras!

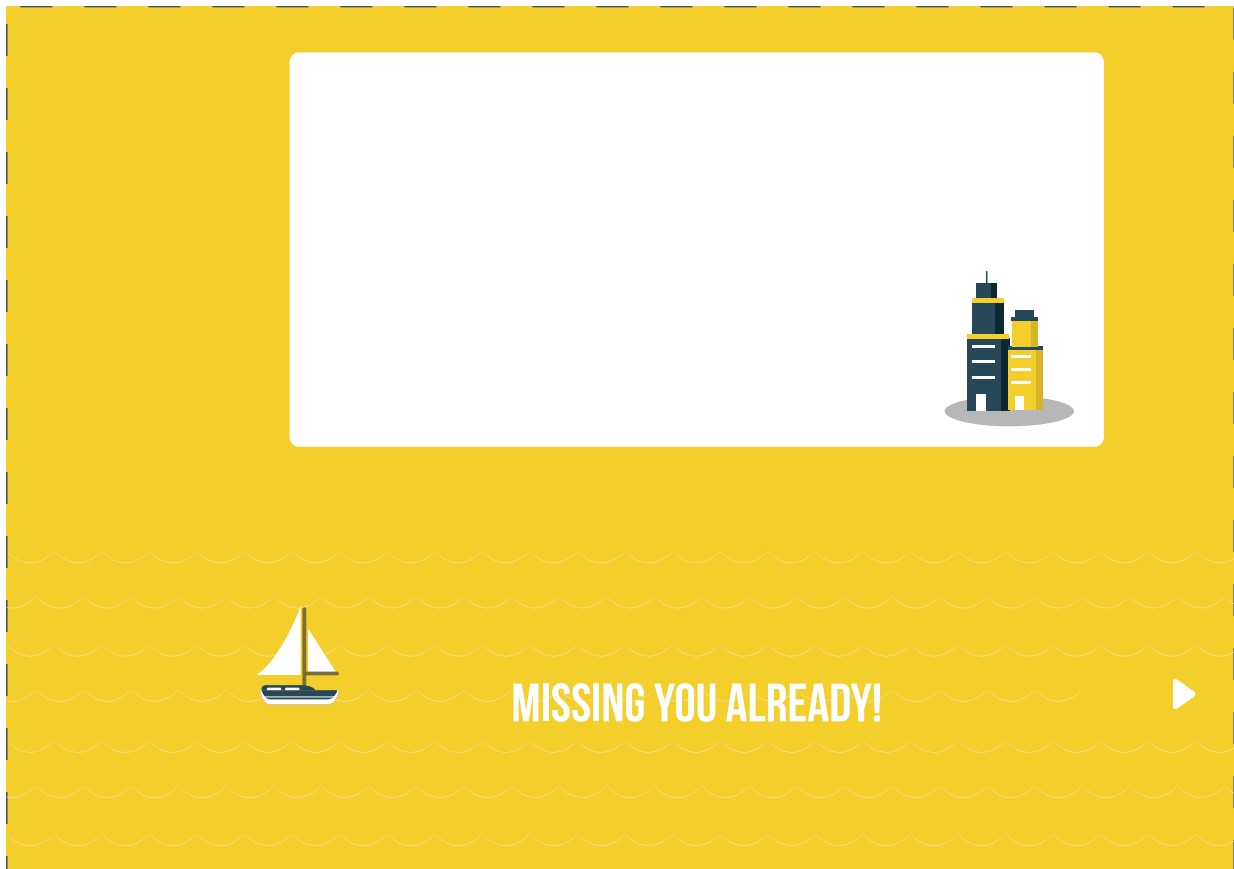

C



1

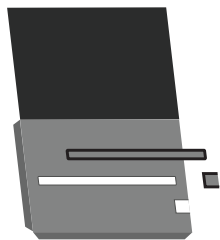

Paste the pink sheet behind A.
Cut out A and the pieces with
the black outline.

2

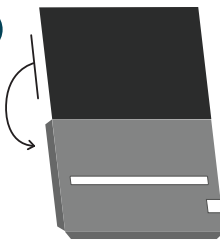

Fold down the back.

3

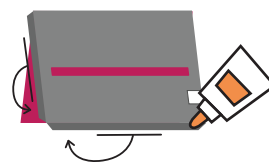

Fold down the two flaps in
and glue the flaps to
the back of the card.

4



Put part C all the way
in the pocket

5



Paste the map marker on
the left most corner of the hole

6



And you're done!